

Light Up Inflatable Instructions

Safety Information

Please read and understand this entire manual before attempting to assemble, operate or install the product.

- This item is not a toy and should be used for decorative purposes only.
- For indoors and outdoors use.

CAUTION:

Do not attempt to inflate your inflatable during unusually strong winds. If it becomes too windy for safe operation, simply allow your inflatable to deflate and wait for better conditions before re-inflating.

CAUTION:

Protect the electric fan and power cord from direct exposure to water. This precaution will reduce the risk of electrical shock. When the temperature is below 14°F (-10°C), the motor may temporarily stop running. The motor will begin functioning again in higher temperatures.

Warning: Read And Understand All Instructions

- Failure to follow all instructions listed below, may result in electric shock, fire and /or serious personal injury.

WARNING : ELECTRICAL PRODUCT

- Keep away from children. Not recommended for children under 3 years of age. As with all electrical products, precautions should be observed during handling and use to reduce the risk of electric shock. If the supply cord is damaged, it must be replaced by the manufacturer, its service agent or similarly qualified persons in order to avoid a hazard.

DANGER

- To prevent electric shock, do not immerse in water; wipe clean with damp cloth. Immersing this product can result in an electric shock.

IMPORTANT NOTE:

Periodically examine this product for damage to the cord, housing or other parts that may result in the risk of fire, electric shock or injury. If the product is damaged, do not use it.



Important Safety Instructions **Read And Follow All Safety Instruction**

When using electrical products, basic precautions should always be followed, including the following:

- This is an electrical product – not a toy! To avoid risk of fire, burns, personal injury, and electric shock, it should not be played with or placed where small children can reach it.
- Do not use seasonal products outdoors unless marked suitable for indoor and outdoor use. When products are used in outdoor applications, connect the product to a Ground Fault Circuit Interrupting (GFCI) outlet. If one is not provided, contact a qualified electrician for proper installation.
- This seasonal use product is not intended for permanent installation or use.
- Do not mount or place near gas or electric heaters, fireplaces, candles, or other similar sources of heat.
- Do not secure product wiring with staples or nails or place on sharp hooks or nails.
- Do not let lamps rest on the supply cord or on any wire.
- Unplug the product when leaving the house, when retiring for the night, or if left unattended.
- Do not use this product for other than its intended purpose.
- Do not hang ornaments or other objects from cord, wire, or light string.
- Do not close doors or windows on the product, or extension cords, as this may damage the wire insulation.
- Do not cover the product with a cloth, paper, or any material not part of the product when in use.

- Do not place the product against carpeting, furniture, or any other fabric when in use.
- This product has a polarized plug (one blade is wider than the other) as a feature to reduce the risk of electric shock. This plug will fit in a polarized outlet only one way. If the plug does not fit fully in the outlet, reverse the plug. If the plug still does not fit, contact a qualified electrician. Do not use an extension cord unless the plug can be fully inserted. Do not alter or replace the plug.
- Before using and reusing, inspect the product carefully. Discard any products that have cut, damaged or frayed wire insulation cords, cracks, lamp holders or enclosures, loose connections, or exposed copper wire.
- When storing the product, carefully remove the product from wherever it is placed, including trees, branches, or bushes, to avoid any undue strain or stress on the product conductors, connections and wires.
- When not in use, store neatly in a cool dry location protected from sunlight.
- Read and follow all instructions that are on the product or provided with the product.

SAVE THESE INSTRUCTIONS

Installation

PREPARING FOR INSTALLATION

1. Remove contents from packaging
2. Remove all plastic fasteners and tags. These are part of the packaging and should be discarded.
3. Before beginning assembly of product, make sure all parts in the contents list are present. If any part is missing or damaged, do not attempt to assemble the product.

FAQ

1. Can I continually run the inflatable?

Yes, you can run the inflatable during the day and at night. It is recommended you turn off the inflatable when leaving the immediate area and when retiring for the evening. Otherwise, the inflatable is designed to run continually.

2. Can I leave the inflatable up in extreme weather conditions or freezing temperatures?

It is recommended you take appropriate precautions to protect the unit. The inflatable will operate at temperatures below freezing, but it is not recommended to operate the inflatable if temperature drops below 14°F (-10 C°).

3. What if it is raining or snowing? Will this affect the inflatable?

Operation of the inflatable during light weather conditions such as a gentle rain or snowfall is intended. However, operation of the inflatable during extreme weather conditions is not recommended, as your item may become damaged or inundated with moisture. Do not store the inflatable when it is wet.

4. What if water has soaked my unit while unplugged?

Move the unit to a dry location and plug in the unit. The fan will dry the inflatable.

5. The inflatable has been deflated and it is covered with snow. Can I simply re-inflate it?

If the inflatable is covered in a light dusting of snow, simple re-inflation should not harm the unit. However, if the deflated unit has been subjected to a large amount of snow and or ice, do NOT attempt to re-inflate. Rather, carefully remove the item from the extreme condition (i.e. bring it indoors) and allow the unit to thaw before re-inflating. This helps prevent cracks and or tears in the material.

6. When I unplug the inflatable, it deflates. Why is this?

The inflatable will not stay inflated unless it is plugged in and the fan is blowing air.

7. How can I clean the inflatable?

Wipes clean with a damp cloth and allow to dry before storing away.

8. What is the best way to store the inflatable?

Store in a bag, box or other storage container and keep in a cool, dry location.



DO NOT RETURN TO STORE

**THIS PRODUCT CANNOT BE RETURNED
FOR A REFUND AFTER
IT HAS BEEN UNPACKED AND USED.**

**FOR QUESTIONS OR PROBLEMS WITH THIS PRODUCT
PLEASE VISIT BELOW CUSTOMER SERVICE WEBSITE
FOR EXPEDITED ASSISTANCE**

www.toysinquiry.com

CONTENTS AND SPECIFICATION MAY VARY FROM THOSE ILLUSTRATED.

***O*ccasions™**

125, QI WEN ROAD, HAI SHU, NINGBO, CHINA

ALL RIGHTS RESERVED

MADE IN CHINA

PLEASE RETAIN THIS INFORMATION FOR FUTURE REFERENCE.

Package Contents

| Part | Description | Quantity |
|------|--|----------|
| A | Inflatable Unit | 1 PIECE |
| B | Air Blower (Input 110-120V AC 0.54A, 60Hz) | 1 PIECE |
| C | Tether Ropes | 3 PIECES |
| D | Tether Stakes | 3 PIECES |
| E | Stakes | 6 PIECES |
| F | Extra Fuse | 1 PIECE |

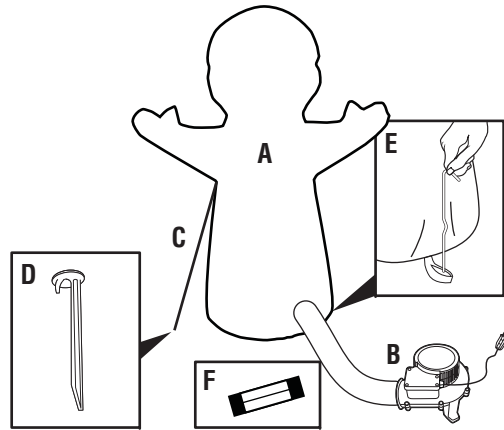

Assembly Introduction

1. Lay out deflated inflatable on a clear and flat. Make sure the blower is clear of fabric or other obstructions.
2. Ensure zipper on inflatable is fully closed.
3. For outdoor use, tie tether ropes to the stakes, clip the nylon loops on the side of inflatable, then insert stakes to the ground making sure tethers are taut.
4. Insert 3 stakes through the plastic legs of the blowers to fix the blower to the ground.
5. Plug the blower into a power unit. Inflatable will start to inflate.
6. Adjust the sealed weight-bag to position your inflatable.
7. To deflate, unplug adaptor and the fan will stop blowing.
8. Unzip the zipper for faster deflation.

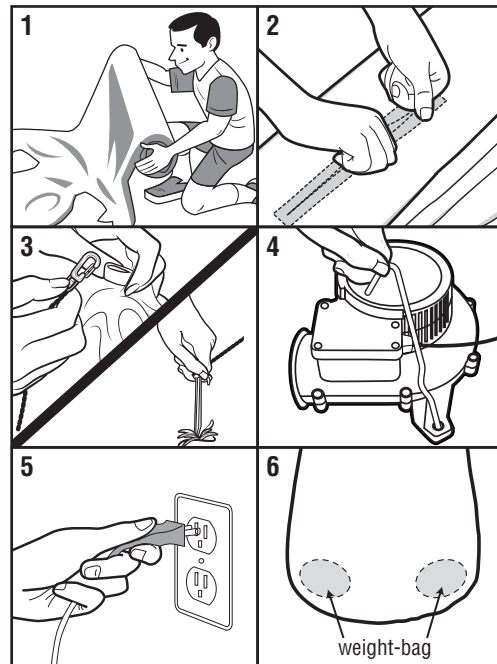

⚠ Caution:

1. For even better night time illumination, you may choose to place an outdoor approved spotlight in front of your inflatable. (Outdoor approved spotlight not provided). Do not place the bulb too close to the inflatable as it may melt or damage the plastic.
2. Do not place any foreign objects inside your inflatable.
3. Do not block air intake area of your inflatable; it will increase the inflation time.
4. During inclement weather conditions such as heavy rain, snow and windstorms, store the product indoors.
5. Operation of your inflatable during extreme weather conditions is not recommended.
6. Do not store the inflatable when it is wet.

⚠ Important Safety Instructions: Power Unit

This power unit is intended to be correctly orientated in a vertical or floor mount position. When using electrical products, basic precautions should always be practiced including the following:

1. READ AND FOLLOW ALL SAFETY INSTRUCTIONS.
2. Read and follow all instructions that are on the product or provided with the product.
3. For a cord-connected or direct plug-in power unit, do not use an extension cord.
4. Reference the National Electrical Code, ANSI/NFPA 70, specifically for the installation of wiring and clearances from power and lighting conductors.
5. Installation work and electrical wiring must be done by qualified person(s) in accordance with all applicable codes and standards, including fire-rated construction.
6. For a cord-connected or direct plug-in power unit, do not install or use within 10 feet of a pool.
7. For a cord-connected or direct plug-in unit, do not use in a bathroom.
8. For a direct plug-in or cord-connected power unit marked in accordance with 65.2:
WARNING: Risk of Electric Shock. When used outdoors, install only to a covered Class A GFCI protected receptacle that is weatherproof with the power unit connected to the receptacle. If one is not provided, contact a qualified electrician for proper installation. Ensure that the power unit and cord do not interfere with completely closing the receptacle cover.
9. For a permanently connected power unit marked in accordance with 65.2:
WARNING: Risk of Electric Shock. When used outdoors, install only on a circuit protected by a Class A GFCI.
10. **WARNING: Risk of Fire.** Installation involves special wiring methods to run wiring through a building structure. Consult a qualified electrician.
11. For a unit intended to be mounted greater than 0.30 m (1 foot) from the ground surface:
WARNING: Risk of Electric Shock. Mount the unit at a height greater than 1 foot from the ground surface.
SAVE THESE INSTRUCTIONS – This manual contains important safety and operating instructions for power units.

Use And Care Instructions

1. Before using and reusing, inspect the product carefully. Discard any product that has cut, damaged or frayed wire insulation cords, cracked lamp holders or enclosures, loose connections, or exposed copper wire.
2. Wipe the unit with a damp cloth and allow the unit to dry before storing.
3. When storing the product, carefully remove it from wherever it is placed, including trees, branches, or bushes to avoid any undue stain or stress on the product conductors, connections and wires.
4. When not in use, store neatly in a cool, dry location protected from sunlight.

User Servicing Instruction

Replace the fuse:

1. Grasp plug and remove from the receptacle or other outlet device. Do not unplug by pulling on the cord.
2. Open the fuse cover. Slide opens the fuse access cover on top of the attachment plug towards blades. (See Illustration)
3. Remove fuse carefully.
4. Risk of fire: Replace fuse only with 5 Amp, 125V fuse (provided with product)
5. Close the fuse cover. Slide close the fuse access cover on top of the attachment plug.
6. Risk of Fire: Do not replace the attachment plug. Contains a safety device (fuse) that should not be removed. Discard product if attachment plug is damaged.

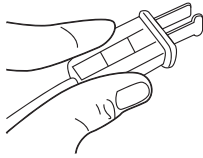

CAUTION: To reduce the risk of fire or electric shock, do not attempt to replace lamps or modify string.

CAUTION: To reduce the risk of fire do not deliberately reposition either lamp holder contact.

CAUTION: Do not attempt to inflate your inflatable during unusually strong winds. If it becomes too windy for safe operation, simply allow your inflatable to deflate and wait for better conditions before re-inflating.

CAUTION: Protect the electric fan and power cord from direct exposure to water. This precaution will reduce the risk of electrical shock. When the temperature is below 14°F (-10°C), the motor may temporarily stop running. The motor will begin functioning again in higher temperatures.

Troubleshooting

Problem: The unit is not inflating.

- The power source is disabled or the cord may be unplugged. Check all power cables to make sure that they are properly connected to a power source. Ensure that the power outlet has power.
- Debris may be lodged in the motor. Unplug fan unit and remove any foreign objects or debris from the motor.

NOTE: Periodically, the inflatable air-intake area may become clogged with grass, leaves or other debris. For best results, it is recommended to check this air-intake area and clean as necessary.

- Occasionally, the hanging fabric of a partially inflated inflatable can become attached to the motor's air- intake area. Ensure that fabric is not hanging near the motor during inflation.
- The zippers that seal the inflatable may not be completely closed. Make sure the zipper is zipped closed.
- The temperature may be below 14°F (-10°C). Remove the unit from extreme temperatures until weather conditions improve.
- The connection between the inflatable and fan may not be securely attached.

Problem: The unit is torn.

- You may hand sew rips with any type of thread or use clear packing tape to cover the tear.

Questions or Problems?

Visit our website www.toysinquiry.com or call our customer service department at 1-800-434-6178 for expedited assistance.